

FEATURES

- Built-in Pressure Regulator
- Heavy-Duty Forged Brass Construction
- Solid Ceramic Plungers
- Innovative Integrated Drive System
- Ultra-High Pressure, Compact Design

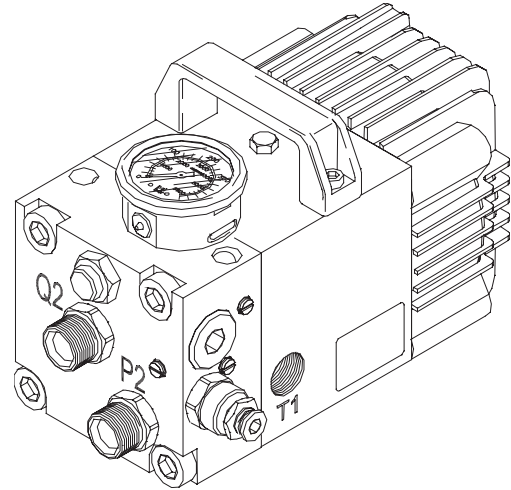

SPECIFICATIONS

Pump Model	HPX808	HPX810	HPX812
Max Discharge Volume	0.6 GPM	1.2 GPM	1.8 GPM
Max Discharge Pressure	11890 PSI	11600 PSI	10150 PSI
Maximum Fluid Temp	110°F		
Maximum Inlet Pressure	150 PSI		
Minimum Inlet Pressure	45 PSI		
Inlet Port - Water	1/2" G-F		
Outlet Port - Water	1/2" G-F		
Flow Factor	0.1	0.2	0.3
Pressure Factor	6.3	4.0	2.8
Max Hydraulic Input PSI	1885 PSI	2900 PSI	3625 PSI
Max Hydraulic Input Vol*	6.1 GPM		
Min Hydraulic Input Vol	3.2 GPM		
Max Hydraulic Return PSI	145 PSI		
Max Hydraulic Oil Temp	145°F		
Hydraulic Inlet Port	1/2" G-F		
Hydraulic Outlet Port	1/2" G-F		
Weight	39.6 lb		
Dimensions	9.3" x 4.2" x 5.1"		

*In order to prevent cavitation, the hydraulic input volume values must not be exceeded

PERFORMANCE*

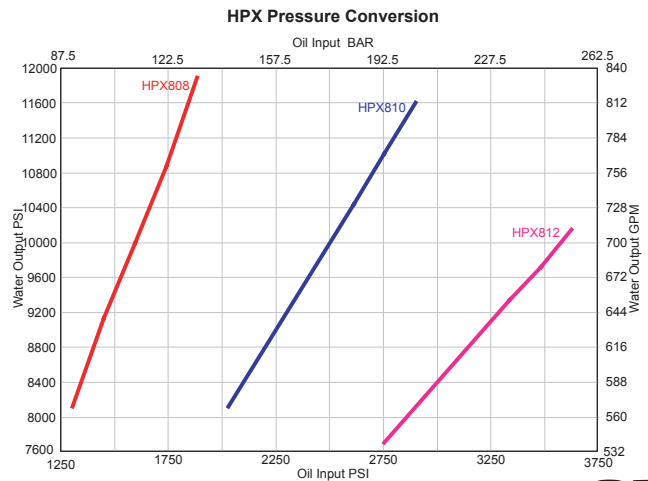
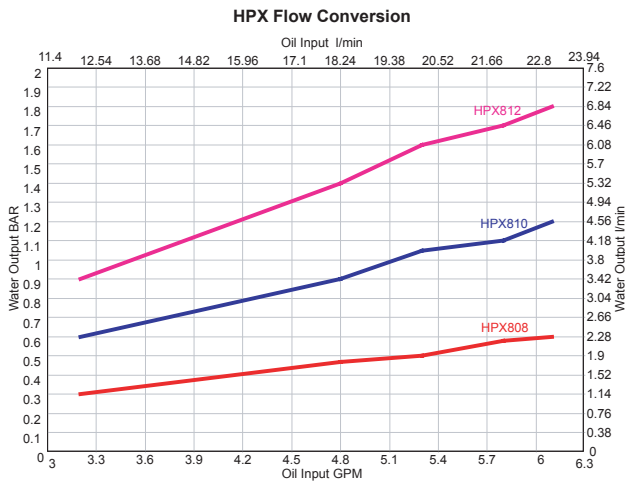

* Actual performance may vary slightly depending on conditions



HPX Series

Hydraulic Drive - Pressure Intensifier

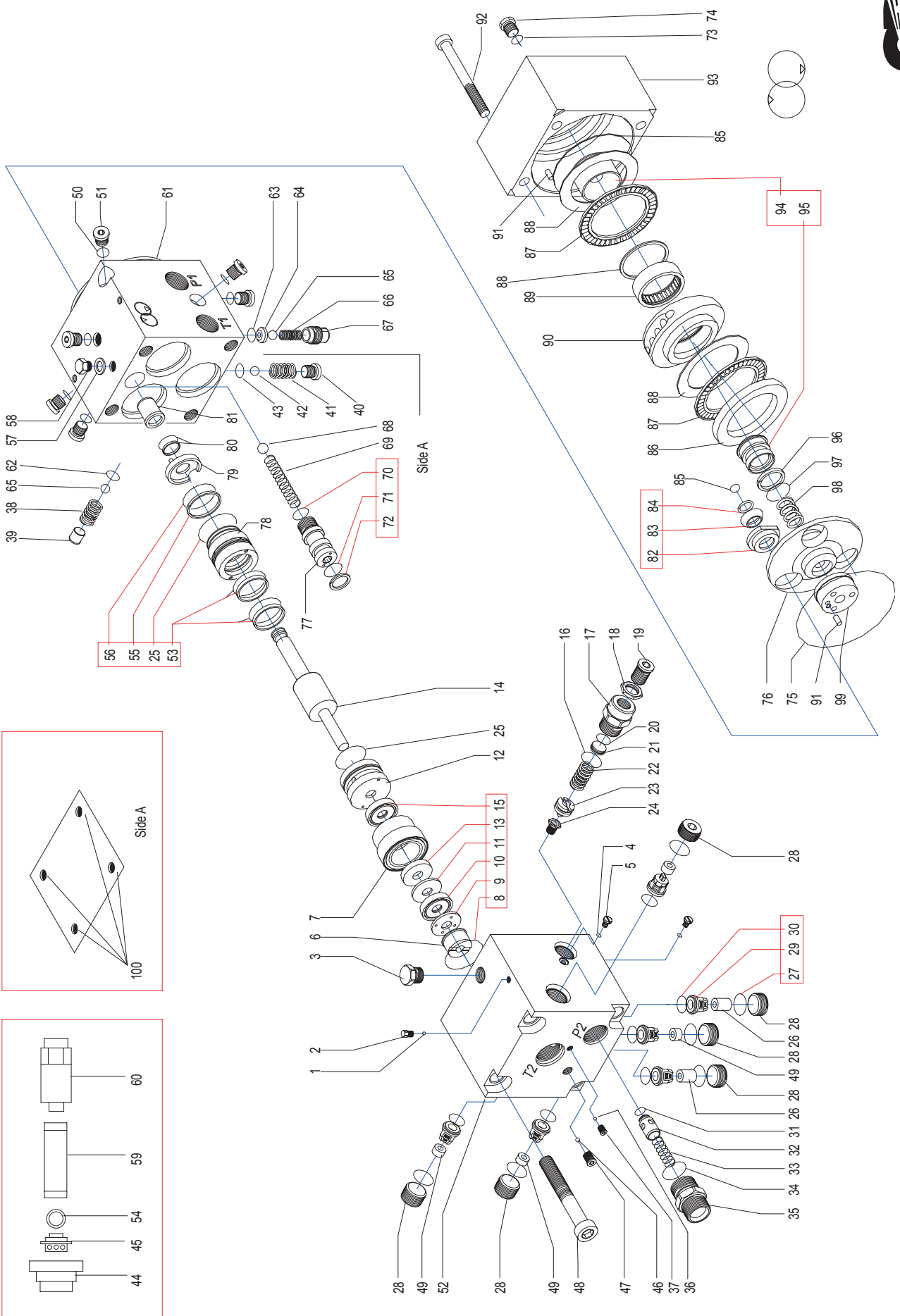

PART LIST

Pos	Part Num	Description	Qty	Pos	Part Num	Description	Qty	Pos	Part Num	Description	Qty
1	P0300010	Stainless steel ball Ø 4	3	31	P02100070	O-R 6 x 3 - 90° Sh	1	65	P03000080	Ball Ø 7	2
2	P03300020	Plug M7 x 0.75	3	32	P03700030	Back relief valve	1	66	P01900140	Ventil valve spring	1
3	P03300160	Plug 1/4 BSP	1	33	P01900100	Back relief valve spring	1	67	P03300200	Ventil valve plug	1
4	P02100010	O-R 2.5 x 1.5 - 90° Sh	2	34	P02100270	O-R 15.3 x 2.4 - 90° Sh	1	68	P03000090	Ball Ø 8.5	1
5	P03300010	Plug M4 x 5	2	35	P02000020	SS outlet nipple Pg 13.5	1	69	P01900130	Oil inlet safety spring	1
6	P01100090	Upper spacer HPX808	3		P02000040	SS outlet nipple R 1/4"		70,71,72	P180	Oil seal KIT	1
	P01100100	Upper spacer HPX810		36	P03000070	Stainless steel ball 5.5	2	73	P02100540	OR 17.17x1.78 90° sh	1
	P01100110	Upper spacer HPX812		37	P03800020	Bolt STEI M8x1.75xL8	2	74	P03300230	Plug 1/4"	1
7	P00600110	Spacer HPX808	3	38	P01900120	Valve spring	1	75	P02100420	OR 86 x 2 - 70° Sh A	1
	P00600120	Spacer HPX810		39	P03300140	Valve plug	1	76	P03900010	Swaying disk	1
	P00600130	Spacer HPX812		40	P03300100	Plug Ø 6.5x8.5	1	77	P03300110	Plug pg 9	1
8,9,10,	P160	HP seals KIT HPX808	1	41	P01900030	Spring	1	78	P00600180	Oil seal bushing	3
11	P150	HP seals KIT HPX810		42	P03000050	Stainless steel ball Ø 3.5	1	79	P01100120	Sync shaft spacer	3
13,15	P140	HP seals KIT HPX812		43	P02100030	O-R 2.78 x 1.78 - 90° Sh	1	80	P03600010	Turcon-Glyd Ø 12	3
12	P00600030	Int. bushing HPX808	3	44	P03300050	Filter cup	1	81	P00600010	Sync shaft guide	3
	P00600040	Int. bushing HPX810		45	P01200020	Oil distributor	1	82,83,84	P085	Piston retainer KIT	1
	P00600050	Int. bushing HPX812		46	P03000030	Stainless steel ball Ø 6	2	85	P02700010	Shim 68 x 55 x 0.1	a/r
14	P92400070	Complete piston HPX808	3	47	P03800030	Screw M10x1xL8	2		P02700020	Shim 68 x 55 x 0.2	a/r
	P92400060	Complete piston HPX810		48	P03800090	Screw M12 x 110	4		P02700030	Shim 68 x 55 x 0.3	a/r
	P92400050	Complete piston HPX812		49	P01100010	Valve spacer 5.25x10x5	1		P02600020	Bearing th. 4mm	1
16	P02100350	O-R 15.6 x 1.78 - 90° Sh	1	50	P02100110	O-R 8.5 x 1.5 - 90° Sh	6	86	P02600010	Niddle bearing	2
17	P00900070	Overload valve body	1	51	P03300080	Plug M10 x 0.75	6	87	P02600010	Flat bearing	3
18	P00800010	Reg. lock nut M12x1 h3	1	52	P03500060	Brass head	1	88	P02600030	Swash plate assembled	1
19	P03800010	Overload valve screw	1	25,53,55,56	P050	Oil bushing seals KIT	1	89,90	P92300020	Pin Ø 4x8	2
20	P02100150	O-R 10.5 x 1.5 - 70° Sh	1	54	P02100380	O R 27x2 70° sh	1	91	P03200010	Pin Ø 4x8	2
21	P01100130	Overload valve spacer	1	57	P02800010	Washer with gasket Ø 8	1	92	P03800070	Screw M8 x 080	4
22	P01900060	Overload reg. spring	1	58	P03300030	Plug M8 x 0.75	1	93	P01000020	Brass bottom	1
23	P92200030	Overload shutter Ø 2.5	1	59	P01300010	Sieve	1	94,95	P85400120	Oil distribution KIT	1
24	P02900060	Overload valve seat	1	60	P00900010	Filter w/OR (P02100310)	1	96	P00200050	Back ring 25x19.3x1.5	1
25	P02100390	OR 32 x1.5	3	61	P00900020	Brass housing	1	97	P02100330	O-R 19 x 3 - 90° Sh	1
26	P01100020	Valve spacer 11.4x10x5	2	62	P02100050	O-R 4 x 3 70 sh	1	98	P01900040	Sliding ball spring	1
28	P03300060	Plug M24 x 1.5 L 24	6	63	P02100140	O-R 10 x 1.3 - 90° Sh	1	99	P01200010	Brass oil distributor	1
27,29,30	P170	Outlet valve KIT	1	64	P02900070	Ventil valve seat	1	100		Fixing holes	4

REPAIR KITS

Kit No.	P050	P085	P140	P150	P160	P170	P180
Model	All	All	HPX812	HPX810	Hpx808	All	All
Items included in kit	25, 53, 55, 56	82, 83, 84	8, 9, 10, 11, 13, 15	8, 9, 10, 11, 13, 15	8, 9, 10, 11, 13, 15	27, 29, 30	70, 71, 72
Pos. in kit	1	1	1	1	1	1	1

TORQUE SPECS*

Item	Kg	Ft/lb	Nm
3	2.5	18	25
19	.75	5	7
28	4	29	39
48	9	65	88
92	3.25	23	32

*Decrease torque by 20% if threads are lubricated.



GENERAL PUMP

DIMENSIONS

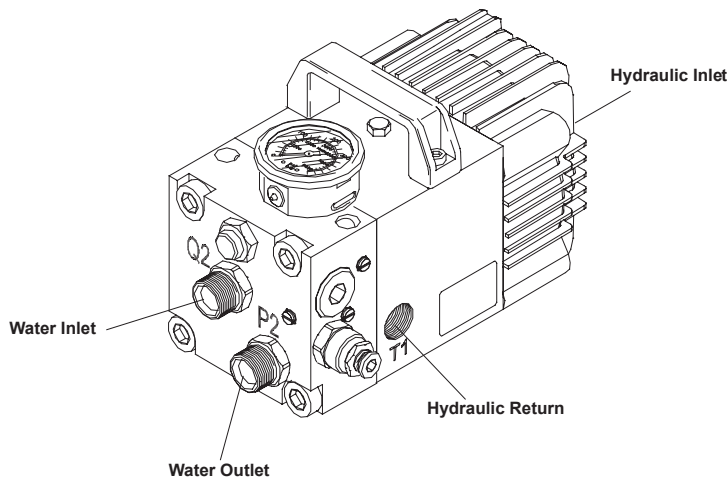
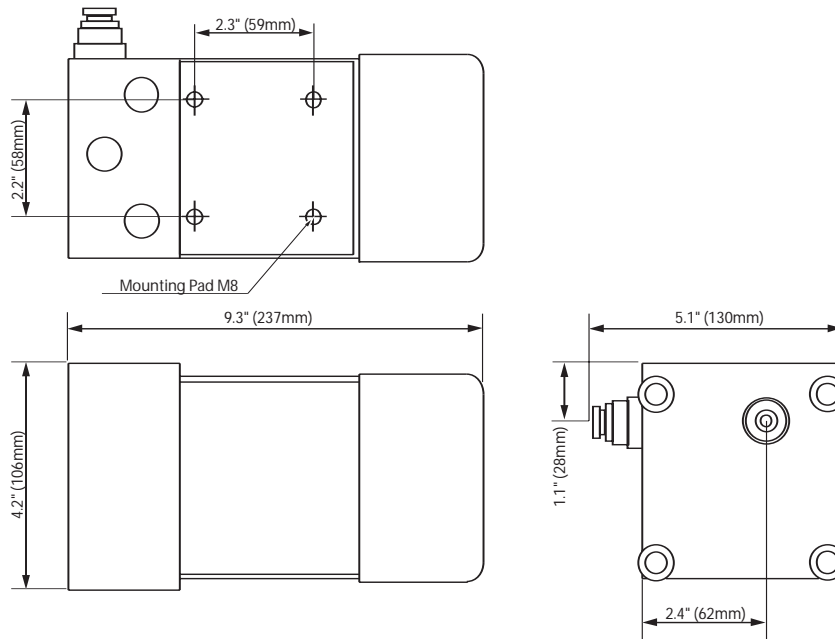

NOTES

Each pump is factory tested for 20 minutes prior to shipment. A serial number is stamped on each pump as an identification code. A label reporting technical data and max working parameters is affixed to each pump. Quality control tests and calibrates each pump to the following specifications.

Model	Inlet Oil Flow	Outlet Water Flow	Oil Inlet PSI	Water Outlet PSI
HPX808	6 GPM	0.6 GPM	1740 PSI	10875 PSI
HPX810	6 GPM	1.2 GPM	2900 PSI	11600 PSI
HPX812	6 GPM	1.8 GPM	3480 PSI	9715 PSI